

SAC METRO AIR DISTRICT ASBESTOS SURVEY INSTRUCTIONS & GUIDANCE

Most renovation and demolition projects require an asbestos survey and notification to the Air District before obtaining a building permit. Asbestos Surveys and Applications can be submitted via our online portal at AirQuality.org/Services by creating an account or logging in if you are already registered, entering project details, and attaching the asbestos survey. There are currently no fees for reviewing asbestos surveys. However, fees and a 10-day notification period may apply to your project if it requires the removal of regulated asbestos containing building materials or if it impacts load bearing/structural elements.

SMAQMD Survey Requirements

- Complete the asbestos survey(s) for you project in accordance with Sac Metro Air Quality [Rule 902 Asbestos, Section 401.1-6, Administrative Requirements, Renovations and Demolitions-Surveys.](#)

Sample Results

Create a table (see example below of minimal information needed to comply with SMAQMD Rule 902) for all samples >1% from all structures surveyed. Category I or Category II materials subject to known mechanical removal or fire damage must be considered RACM.

Example: Building 1 - Sample Results

Sample(s) ID#	Suspect Material	Asbestos Content (%) (PLM/PC)	EPA Category	Total Quantity Sq./Ln/Cu. Ft.
1	Ceiling tile	2.6-PC	RACM	250 sqft
4	Linoleum	40-PLM	RACM	800 sqft
5	Floor mastic	1.4-PC	RACM (mechanical removal)	250 sqft
14,16, 18	TSI	80-PLM	RACM	1,200 li.ft.
15,17, 19	Wall texture	3-PC	RACM	2,500 sqft
21	Floor tile	8-PLM	CAT II	2,500 sqft
20	Transite panels	45-PLM	CAT II	1,100 sqft
23	Nicolite felt	Assumed	RACM	12,000 sqft
24	Roof mastic	2-PLM	CAT I	12,000 sqft
29, 30, 31	Stucco	1.7 PC	RACM	5,400 sqft

Findings and Recommendations

- Explain the significance of the laboratory results. For example, state that Category I materials may be left in place during demolition (if this aligns with the clients' goals) and that RACM and Category II material must be removed prior to the renovation or demolition if they will be impacted. Explain that the amounts listed are to be used by the owner or project manager to obtain accurate bids from abatement contractors. State whether this is a jurisdictional project under the requirements of the federal NESHAP and SMAQMD Rule 902. For unimpacted areas in a renovation, state that untested suspect materials must be tested prior to additional future projects where the materials will be disturbed.
- Point Count (PC) all samples that are determined to contain <10% asbestos by PCM laboratory results.
- Provide current proof of certification of person who conducted Point Count.

Your Asbestos Survey May be Rejected if:

- Survey form or Appendices are incomplete, incorrect or missing attachments.
- All suspect materials are not sampled or assumed to be asbestos containing in the survey (for any reason).
- Affected suspect materials are not sampled utilizing the 3,5,7 protocol listed in Rule 902, Section 4101.1b.
- Point Counts were not conducted, sheetrock was not composite sampled, non-sheetrock materials were composite sampled.
- "Limited Surveys or Inaccessible Areas"- The SMAQMD is aware that renovations may impact only specific areas within a structure and therefore will not require sampling throughout the entire structure as a demolition survey would require. Stating that a survey is "limited" because all areas of the project will not be impacted or areas are inaccessible will result in rejection of the survey unless good cause is provided. Additionally, there is no requirement to sample inaccessible materials, ie, materials behind a wall or encased in concrete; however, state in the "Findings & Recommendations" that upon discovery of previously untested, inaccessible suspect materials, work in that area must cease until further sampling is conducted. Locked rooms or spaces above drop ceiling tiles are not considered inaccessible and are required to be sampled. The owner/operator must provide access to all areas impacted by the renovation/demolition.

Required Attachments

Floor Plan Map(s)

- Create a separate Floor Plan Map (see example below) for each floor or area of every structure surveyed. If the roof or exterior is impacted by the project, create a separate map for the roof and exterior or include them on one of the floor maps as seen below. Name each room sampled by the commonly used name and state whether the area is undergoing Renovation or Demolition. A demolition is the wrecking, taking out or burning of any load supporting structural member. A renovation is everything else. If the survey is conducted after the Renovation/Demolition has occurred, inspect all dumpsters outside of building. Record the location of each sample taken and identify each sample with a unique identifier that will be the same as reported to the laboratory and in the following appendices. Use “+” to describe >1% or “-” to describe = to or 1% Asbestos

Example: Building 1 - Floor Plan Map

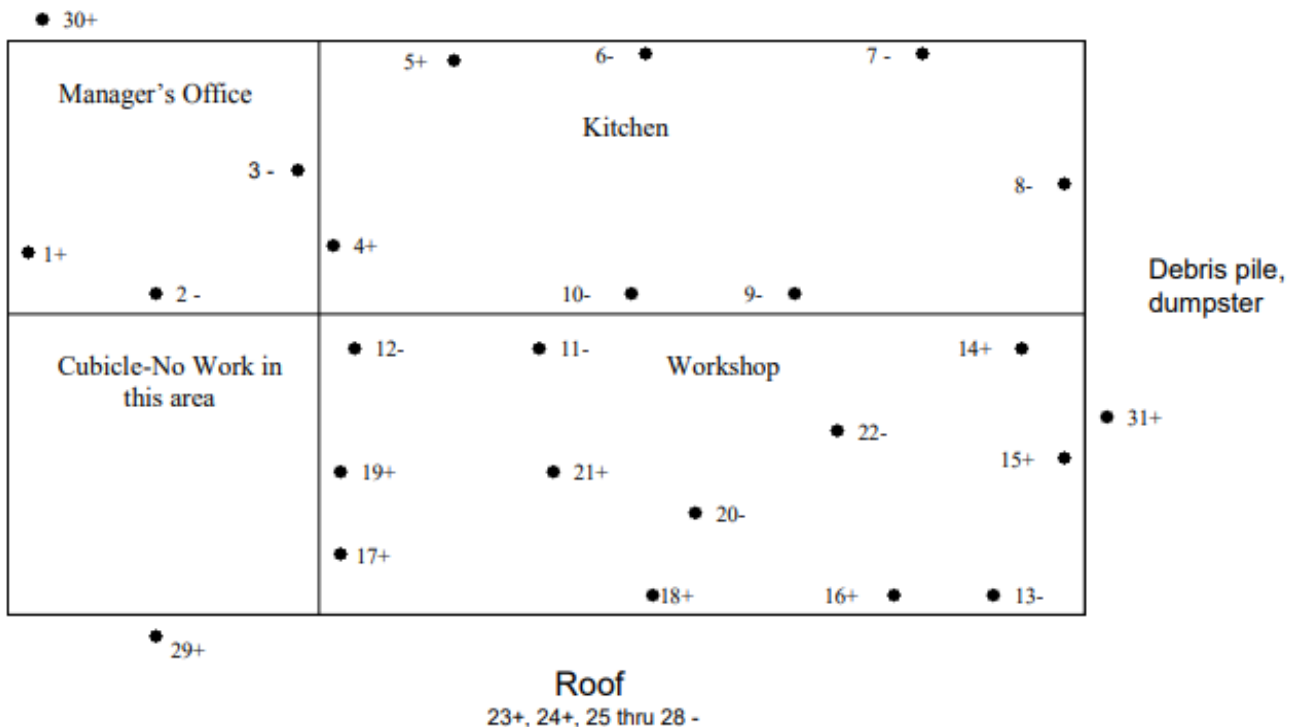

Please contact Sac Metro Air District staff for questions regarding asbestos program requirements at 279-207-1122, Option 6 or email us at asbestos@airquality.org.